

- BENSON CTP STUDY AREA
- DRAFT**
- 2045 VOLUME TO CAPACITY RATIOS**
- UNDER CAPACITY (0-0.79)
- NEAR CAPACITY (0.80-0.99)
- OVER CAPACITY (1.00-1.49)
- SIGNIFICANTLY OVER CAPACITY (1.50-1.99)

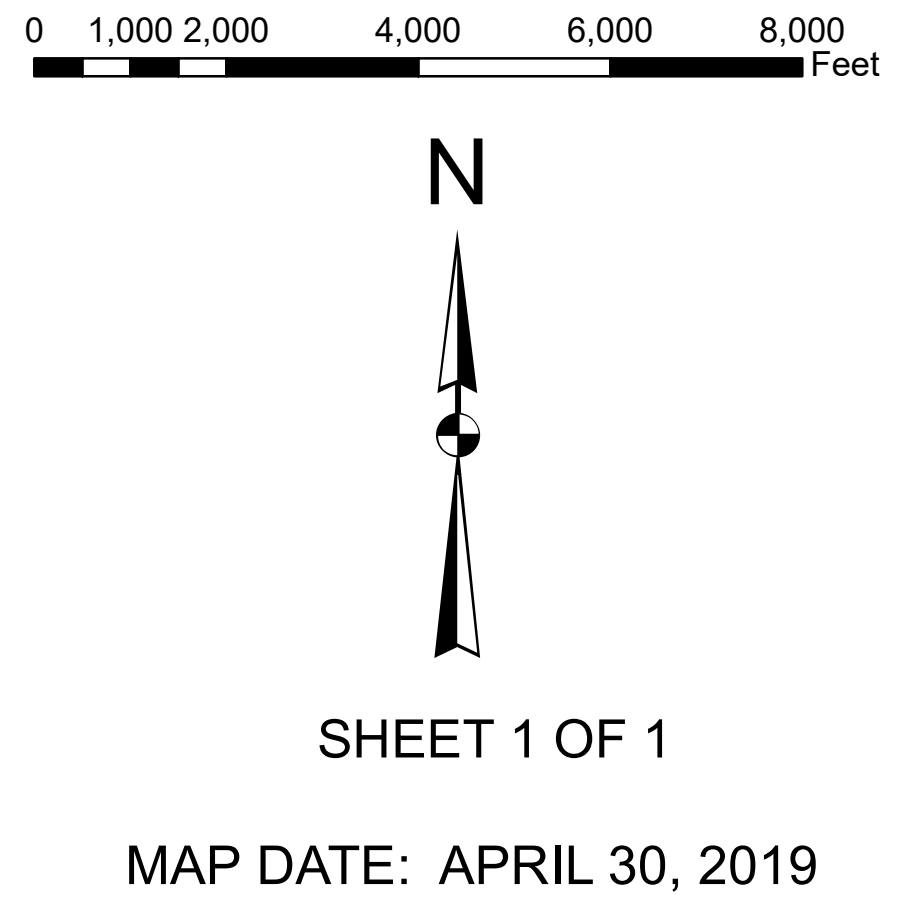

FUTURE (2045) ROADWAY DEFICIENCY MAP

TOWN OF BENSON
COMMUNITY TRANSPORTATION PLAN

VOLUME TO CAPACITY RATIOS ARE BASED ON AVERAGE ANNUAL DAILY TRAFFIC, NOT PEAK HOUR VOLUMES. DATA SOURCE: NCDOT TRAFFIC SURVEY GROUP